

# Power Feedthru DN16CF/500V

## Power Feedthru DN16CF Flange, 500V ..... 2, 4 and 8 Pins

- ✦ Electrical Power Feedthru
- ✦ CF16 S/S Flange (1.33"CF)
- ✦ Alumina insulated conductors
- ✦ Rating 500V DC, up to 10A
- ✦ UHV compatible
- ✦ Bakable to 450 °C

2-Pin Example

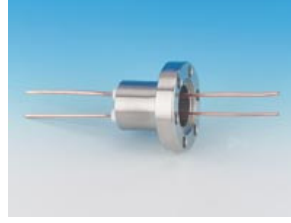

4-Pin Example



P/N	# of Pins	Amps/Pin	Material	Pin Dia	Vac side Pin Length
DN16CF-500V-2-Ni-K	2	2A	Ni	0.032"	1.7"
DN16CF-500V-2-SS-K	2	<1A	S/S	0.032"	1.57"
DN16CF-500V-2-Cu-K	2	3A	Cu	0.032"	1.57"
DN16CF-500V-2-Mo-K	2	10A	Moly	0.032"	1.7"
DN16CF-500V-4-Ni-K	4	2A	Ni	0.032"	1.7"
DN16CF-500V-4-SS-K	4	<1A	S/S	0.032"	1.57"
DN16CF-500V-4-Cu-K	4	3A	Cu	0.032"	1.57"
DN16CF-500V-4-Mo-K	4	10A	Moly	0.032"	1.57"
DN16CF-500V-8-Ni-K	8	2A	Ni	0.032"	1.07"
DN16CF-500V-8-SS-K	8	<1A	S/S	0.032"	1.2"
DN16CF-500V-8-Cu-K	8	3A	Cu	0.032"	1.07"
DN16CF-500V-8-Mo-K	8	10A	Moly	0.032"	1.07"
DN16CF-500V-2-Ni-I	2	5A	Ni	0.032"	1.52"
DN16CF-500V-2-Cu-I	2	16A	Cu	0.032"	1.52"
DN16CF-500V-2-Mo-I	2	8A	Moly	0.032"	1.52"

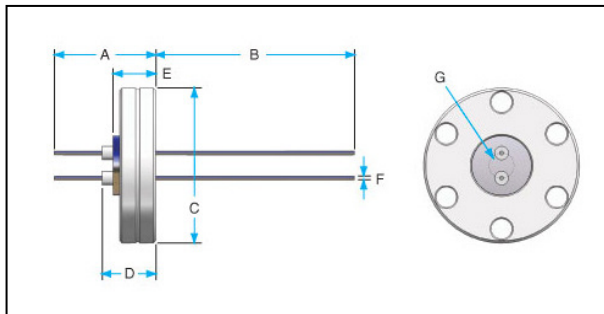

VIN KAROLA INSTRUMENTS

P.O. Box 922273  
Norcross, GA 30010-2273  
Tel: 770/409-1499  
Fax: 770/447-8045  
e-mail: info@vinkarola.com

Vin Karola reserves the right to make changes in Design, and specifications without notice or obligation.  
© Vin Karola Instruments, 2003-2008